

H14 TURBO RIGGING KIT

TURBO RIGGING KIT 8020000

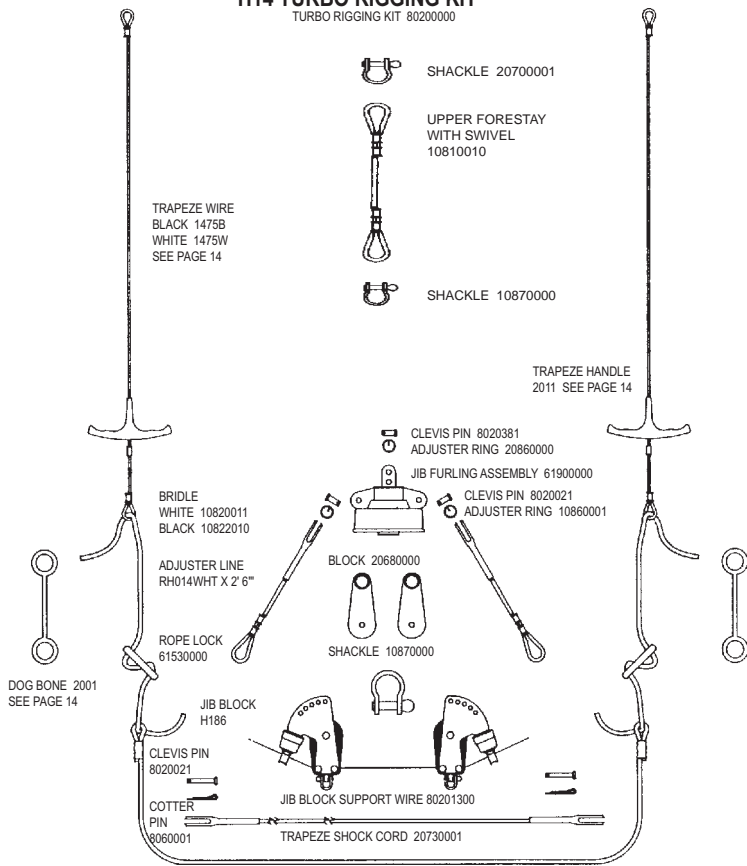

H14 Rivet Guide

() = Quantity needed to fasten part

| | |
|---|--------------|
| Mast | |
| Head | 8010131 (2) |
| Halyard Hook | 8010181 (2) |
| | 8011291 (2) |
| Tang | 8010181 (6) |
| | 8011291 (6) |
| Halyard Cleat | 8010121 (2) |
| Base | 8010131 (3) |
| Sidebar | |
| Chain Plate | 8010181 (3) |
| Rear Crossbar | |
| Corner Casting | 8011231 (6) |
| Traveler Track | 8010201 (18) |
| or | 8010161 (18) |
| Pad Eye | 8010181 (2) |
| Swivel Jam Cleat | 8010201 (1) |
| | 8031501 (2) |
| | 8031231 (1) |
| | 8050801 (1) |
| | 8080101 (1) |
| Boom | |
| Front End Cap | 8010131 (3) |
| Tang | 8010181 (4) |
| Barrel Cleat | 8010181 (2) |
| Block Hanger | 8010181 (4) |
| Rear End Cap | 8010131 (3) |
| Front Crossbar | |
| Mast Step | 8011231 (4) |
| Corner Casting | 8011231 (6) |
| Rudder Assembly | |
| Upper Casting (Underside) | 8010131 (2) |
| Tiller End Cap | 8011231 (1) |
| | 8010131 (2) |
| Sail | |
| Headboard | 8010020 (16) |
| Tack/Clew plate | 8010020 (6) |
| Pocket Protector | 8010020 (4) |
| (Requires setting machine-not available as hand tool) | |

H16 Rivet Guide

() = Quantity needed to fasten part

| | |
|---------------------------|--------------|
| Mast | |
| Head | 8010131 (4) |
| Halyard Hook | 8010181 (2) |
| | 8011291 (2) |
| Tang | 8010181 (12) |
| | 8011291 (12) |
| Halyard Cleat | 8010121 (2) |
| Base | 8010131 (3) |
| Downhaul Cheek Block | 8010181 (4) |
| Front Crossbar | |
| Corner Casting | 8011231 (6) |
| Mast Step | 8011231 (4) |
| Jib Track | 8010201 (6) |
| Swivel Jam Cleat | 8010201 (1) |
| or | 801016 |
| Pad Eye | 8031501 (2) |
| Swivel Jam Cleat | 8031231 (1) |
| | 8050801 (1) |
| | 8080101 (1) |
| Rudder Assembly | |
| Upper Casting (underside) | 8010131 (2) |
| Tiller End Cap | 8011231 (1) |
| | 8010131 (2) |
| Boom | |
| Front End Cap | 8010131 (3) |
| Tang | 8010181 (4) |
| Barrel Cleat | 8010181 (2) |
| Block Hanger | 8010181 (4) |
| Rear End Cap | 8010131 (2) |
| Rear Crossbar | |
| Corner Casting | 8011231 (6) |
| Traveler Track | 8010201 (20) |
| Pad Eye | 8010181 (2) |
| Swivel Jam Cleat | 8010201 (1) |
| | 8031501 (2) |
| | 8031231 (1) |
| | 8050801 (1) |
| | 8080101 (1) |
| Sail | |
| Main Headboard | 8010020 (16) |
| Tack/Clew Plate | 8010020 (6) |
| Main Pocket Prtc | 8010020 (4) |
| Jib Clew Plate | 8010020 (16) |
| Jib Pocket Prtc | 8010020 (3) |

H16 HULL

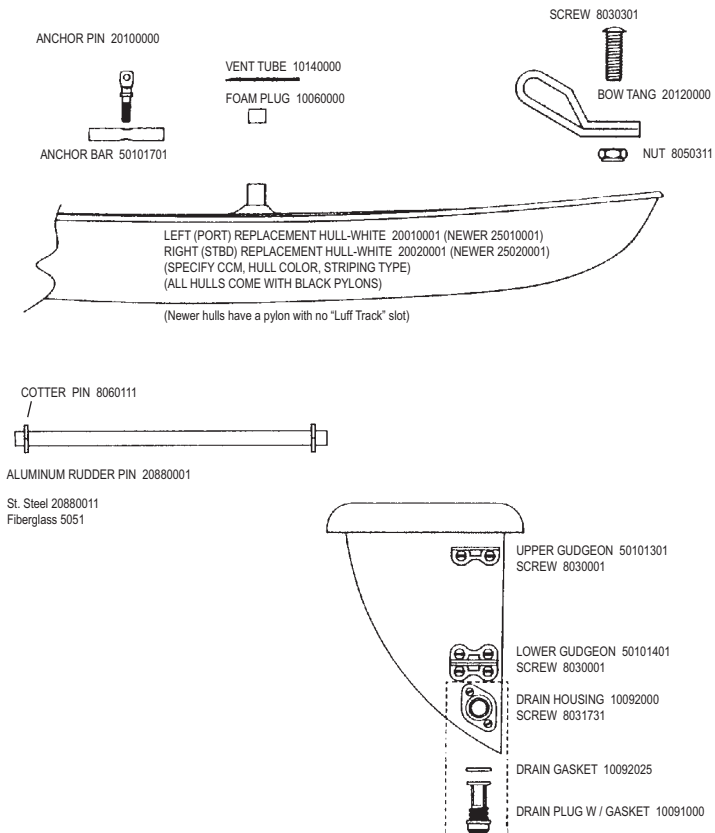

H16 MAST

COMPLETE MAST ASSEMBLY, BLACK 20610000
COMPTIP ASSEMBLY 20611100

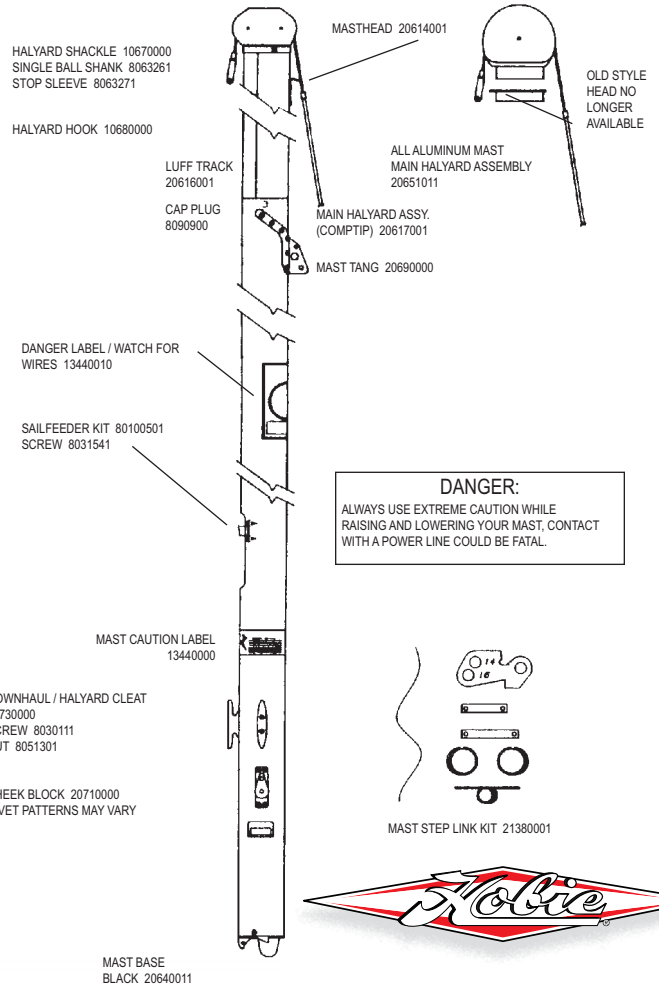

H16 SHROUDS

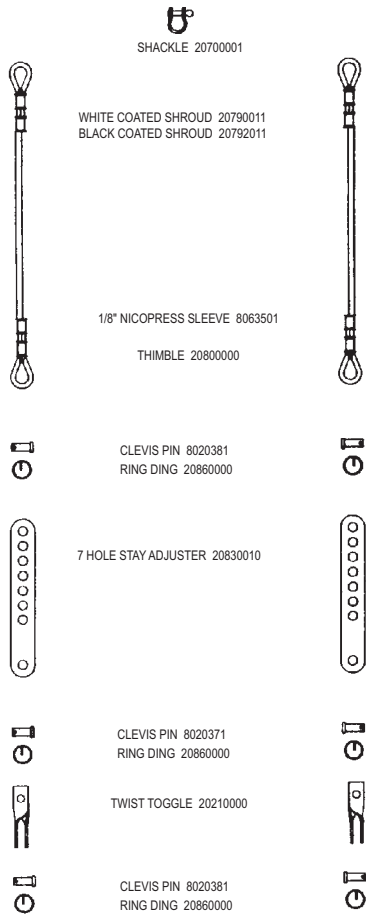

H16 FORESTAY, JIB HALYARD, BRIDLE

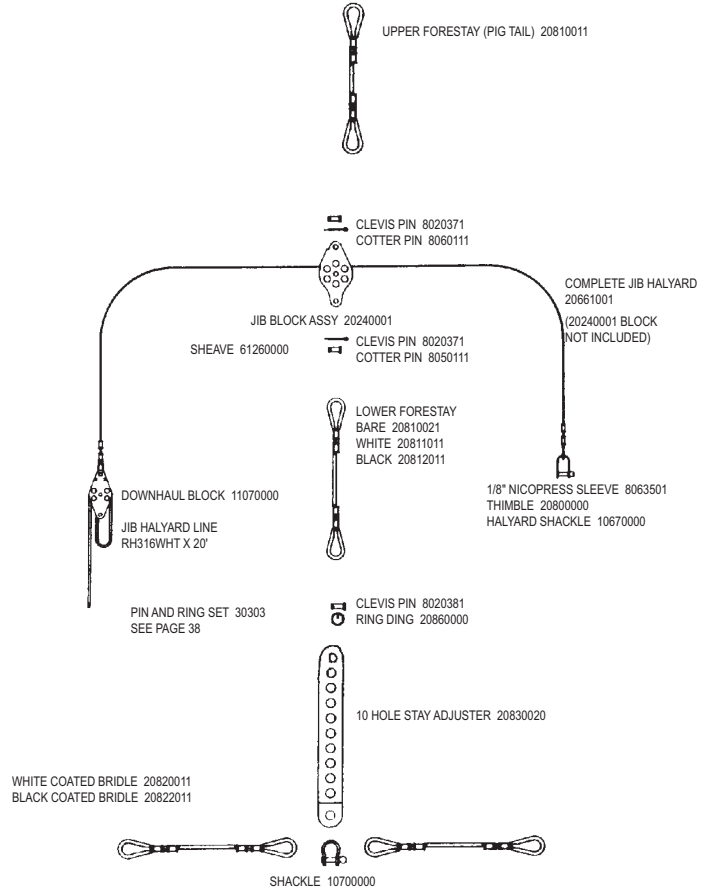

H16 RUDDER

* = SUB ASSEMBLY PART / INCLUDED WITH CASTING

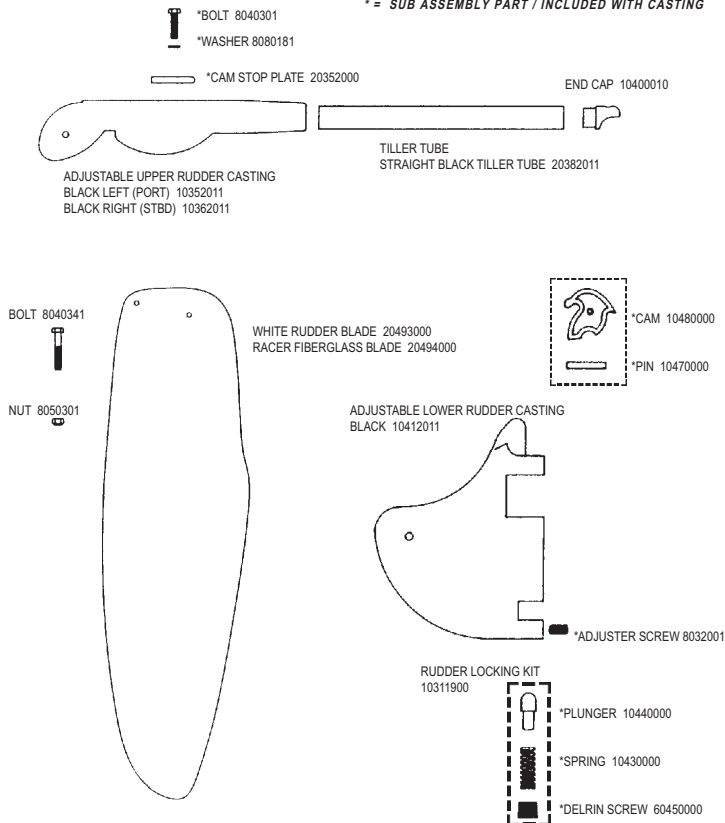

H16 TRAPEZE

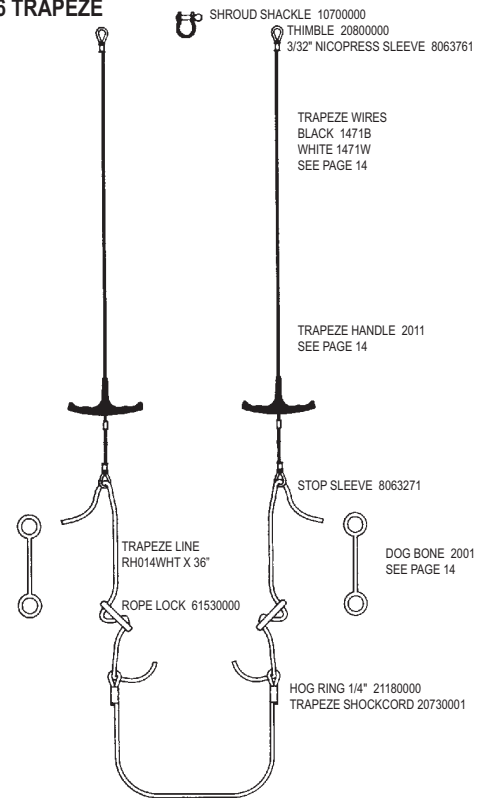

H16 FRONT CROSSBAR

BLACK FRONT CROSSBAR W/MAST STEP / INTEGRATED TRACK 25131910

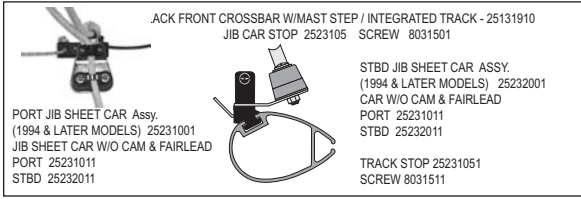

H16 REAR CROSSBAR

ALL YEARS - BLACK REAR (AFT) CROSSBAR w/ INTEGRATED TRACK, WITHOUT CORNER CASTINGS, INCLUDES CAR ACCESS PLATE 25191911

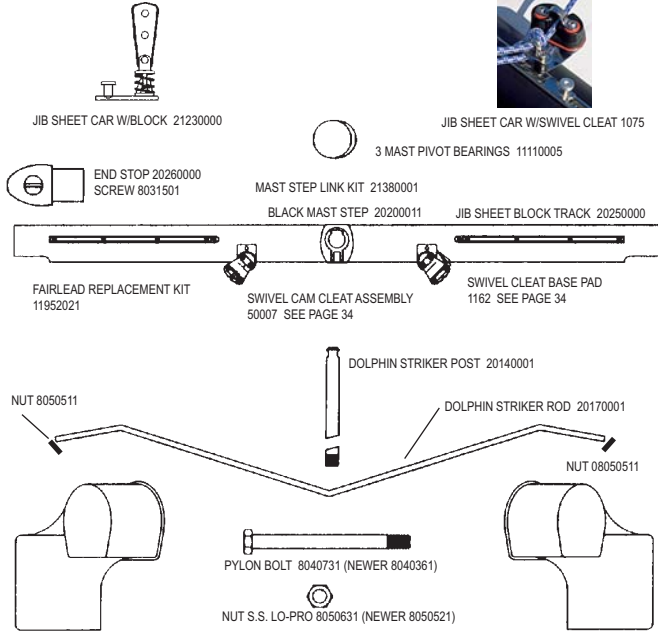
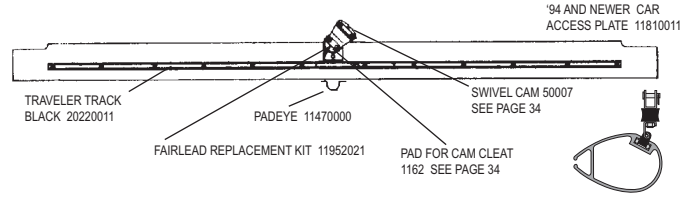

LEFT (PORT) FRONT CORNER CASTING BLACK 10150011
(95-'1) LEFT (PORT) FRONT CORNER CASTING BLACK 10152011

RIGHT (STBD) FRONT CORNER CASTING BLACK 10160011
(95-'1) RIGHT (STBD) FRONT CORNER CASTING BLACK 10162011

* Not all '95 boats had newer style castings / pylons.

(95-'03) FRONT CORNER CASTING JIB TRAVELER SHEAVE
SHEAVE 60620000
RIVET 8011251

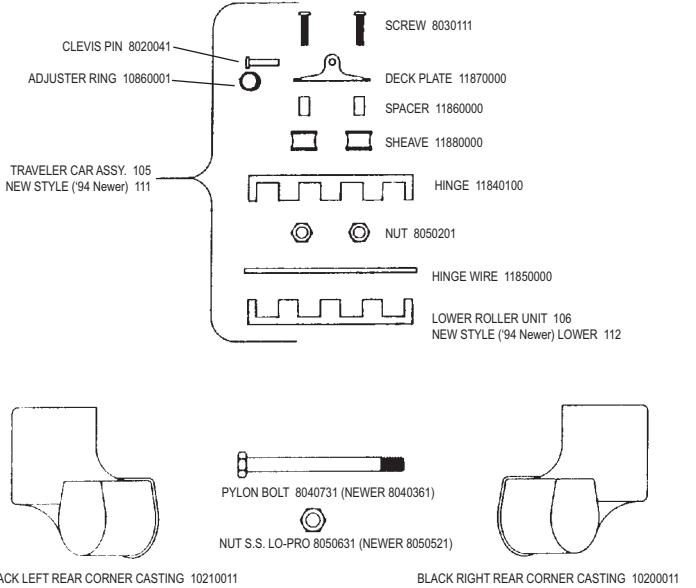

* Not all '94 boats had newer style castings / pylons.

H16 BLOCK SET

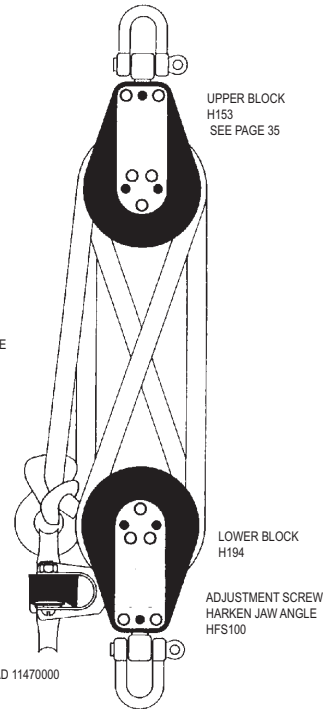

H16 BOOM

BOOM ASSEMBLY
BLACK 20720011

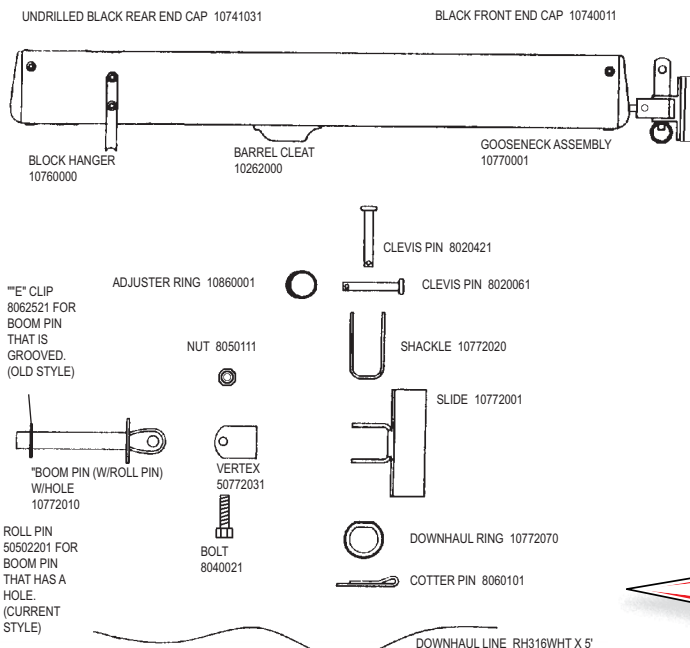

To order from your nearest HOBIE dealer call
1 (800) HOBIE-49
www.hobiecat.com

H16 MAIN SAIL & BATTENS

MAIN SAIL 20991XXX
SEE SEQUENTIAL PARTS LIST
OR SAIL COLOR SELECTION
SHEET, PAGE 20

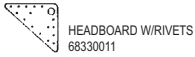

HEADBOARD W/RIVETS
68330011

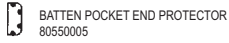

BATTEN POCKET END PROTECTOR
80550005



PAIR OF WHITE HOBIE LOGOS 12430001
PAIR OF BLACK HOBIE LOGOS 12430011



CLASS INSIGNIA 22330000



SAIL WIND INDICATOR 335
SEE PAGE 26

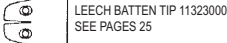

LEECH BATTEN TIP 11323000
SEE PAGES 25

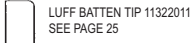

LUFF BATTEN TIP 11322011
SEE PAGE 25



BATTEN TIE LINE
RH112WHT X 18"

SAIL NUMBERS

| # | BLACK | WHITE |
|---------|----------|----------|
| #0 | 12700030 | 12700000 |
| #1 | 12710030 | 12710000 |
| #2 | 12720030 | 12720000 |
| #3 | 12730030 | 12730000 |
| #4 | 12740030 | 12740000 |
| #5 | 12750030 | 12750000 |
| #6 & #9 | 12760030 | 12760000 |
| #7 | 12770030 | 12770000 |
| #8 | 12780030 | 12780000 |



CLEW/TACK PLATE SET 12240000



OUTHHAUL LINE RH316WHT X 74"

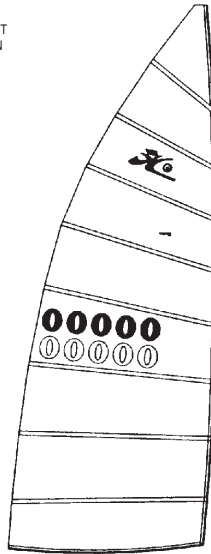

SAIL BAG/COVER 21310000



21000001 HOBIE 16 BATTEN SET
(FOR INDIVIDUAL BATTENS SEE UNIVERSAL BATTENS ON PAGE 25)

H16 JIB SAIL & BATTENS

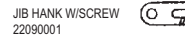

JIB HANK W/SCREW 22090001

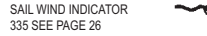

SAIL WIND INDICATOR 335
SEE PAGE 26

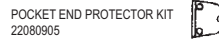

POCKET END PROTECTOR KIT 22080905

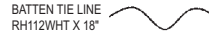

BATTEN TIE LINE
RH112WHT X 18"



JIB SHEET LINE
RM516XXX X 32'
BLUE IS STOCK



BELL SHACKLE 10870000

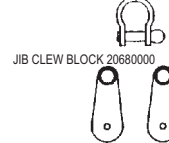

JIB CLEW BLOCK 20680000



ADJUSTABLE JIB CLEW PLATE 22240000



JIB LEACH CAP 21333000

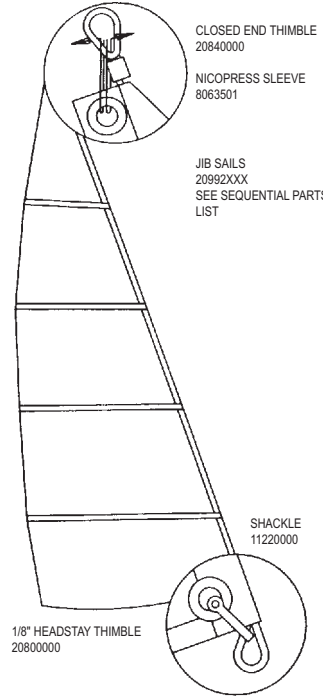

CLOSED END THIMBLE 20840000

NICOPRESS SLEEVE 8063501

JIB SAILS 20992XXX
SEE SEQUENTIAL PARTS LIST

SHACKLE 11220000

1/8" HEADSTAY THIMBLE 20800000

JIB BATTEN SET 20400001



FOR INDIVIDUAL BATTENS SEE
UNIVERSAL BATTENS ON PAGE 25

H16 TRAMPOLINE, SIDEBAR

BLACK SIDEBAR 20270011



COMPLETE TRAMPOLINE (Does not include lace line)
WHITE 20970000
BLACK MESH 20970055
TEAL MESH 20970056
BLUE MESH 20970057
TURQ MESH 20970058

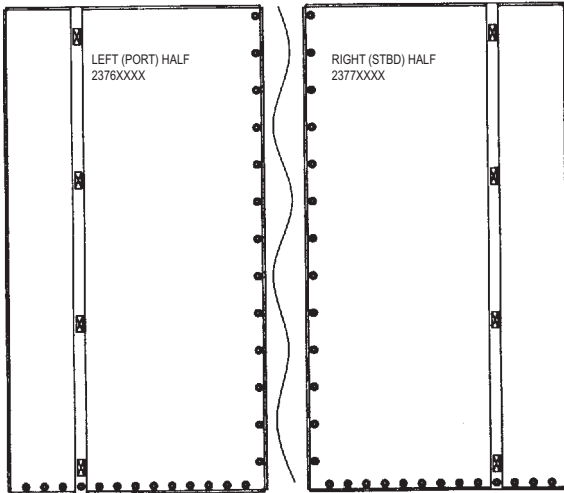

LEFT (PORT) HALF 2376XXXX

RIGHT (STBD) HALF 2377XXXX

CENTER LACING LINE RH014WHT X 20"

REAR (AFT) LACING LINE RH014WHT X 15"

LACING STRIP
WHITE 13780000
BLACK MESH 13780055
TEAL MESH 13780056
BLUE MESH 13780057

H16 TILLER CROSSBAR

TILLER CONNECTOR KIT 11520005

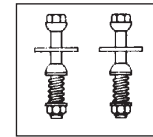

SCREW 8030111
NUT 8050201

FIBERGLASS EXTENSION WITH HINGE 20550001 (79")

HINGE 10532010

EXTENSION TIP 10560000

RUDDER ADJUSTER KIT 60400011

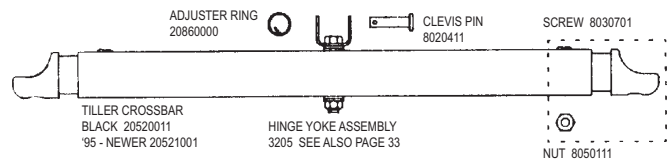

ADJUSTER RING 20860000

CLEVIS PIN 8020411

SCREW 8030701

TILLER CROSSBAR
BLACK 20520011
95 - NEWER 20521001

HINGE YOKE ASSEMBLY 3205
SEE ALSO PAGE 33

NUT 8050111